

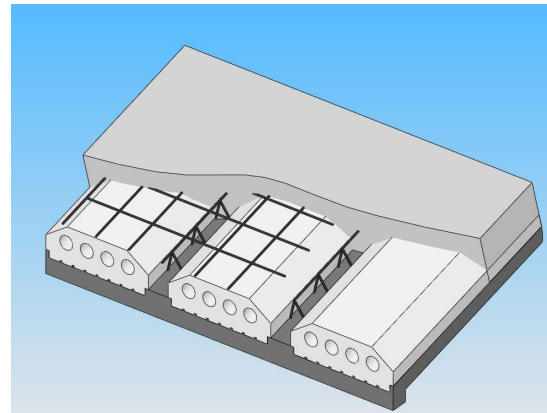

Polimate

YOUR EPS SOLUTIONS



Data Sheet

Model MP01

| | | |
|-----------------|------------------------------|----------------------|
| Dimensions | Moulding Area (width) | 1200mm |
| | Moulding Area (depth) | 1250mm |
| | Moulding Area (height) | 200÷330mm adjustable |
| | Space requirement | 3730x5440x3620mm |
| Connections Ø | Steam | DN80 |
| | Cooling water | 1" ½ |
| | Condenser water | 2" ½ |
| | Air compressed | 1" ½ |
| | Drains | DN125 |
| Pressures (bar) | Vacuum condenser volume | 400 lt |
| | Pressure Filling tank volume | 3x196lt |
| | Fillings connections | 3x12 |
| Consumptions | Steam | 3,5 |
| | Air compressed | 7 |
| | Water | 4 |
| | Energy | 10 kWh/h |
| | Steam | 130÷170Kg/h |
| | Air compressed | 20 m³/h |
| | Water | 15 m³/h |
| | Voltage | 400V~/50Hz |
| | Installed power | kW 25 |

Standard Features

Compact structure in stainless steel designed to facilitate easy transportation, characterized by a horizontal repairable mould chamber and with variable height.

Products can be made with a fixed or continual length (depending on the model) with variable heights and sizes.

Polyurethane based paint with anticorrosion treatment.

Hydraulic mould displacement.

☺ deposits for material loading.

Rational installation of energy distribution and valves connected with flanged joints.

High performance vacuum condenser.

Commercial components from multinational companies present throughout the worldwide market.

Pneumatic installation with compact electrovalve system and filtering group with safety system.

Proportional electronic control of steaming pressure, material injection, which can be selected from the control panel.

Simultaneous display of all parameters and production process times.

Touch screen operating panel with auto-diagnosis system that displays errors and their causes. 50 cycle storage.

Delivery of backup memory support for the processing programmes for fast restoration of functions in case of breakdown.